



**Violetta Tudorache**

+40 729 005 624

contact@blissimobiliare.ro  
(mailto:contact@blissimobiliare.ro)

Updated on 23 November 2020

## **3 bedroom apartment based in Primaverii Residence**

Web Reference  
**#80406**

📍 Primaverii 57 Residence, Primaverii,  
Bucharest

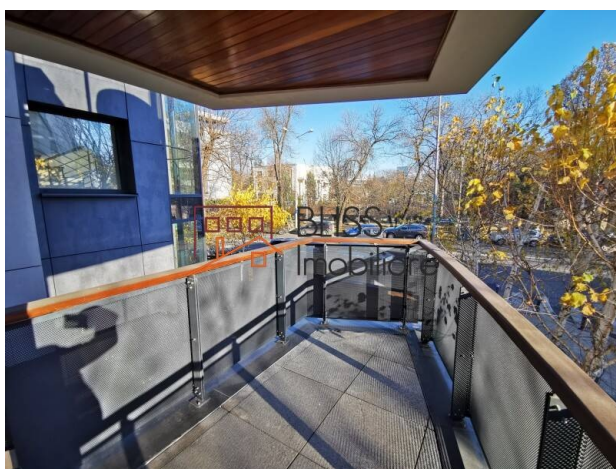

<https://www.blissimobiliare.ro/index.php/en/apartment-3-bedrooms-for-rent-dorobanti-primaverii-kiseleff-aviatorilor-bucharest-80406> (<https://www.blissimobiliare.ro/index.php/en/apartment-3-bedrooms-for-rent-dorobanti-primaverii-kiseleff-aviatorilor-bucharest-80406>)

### **Description**

A special and modern apartment based on the 1st floor of the luxury residential building Primaverii Residence, in a unique area, surrounded by the most beautiful parks of Bucharest, with the advantage of the open perspective through generous glazed surfaces.

## **Quick access to Piața Charles de Gaulle and Aviatorilor metro station**

The apartment is composed of a spacious and bright living room with a dining area, kitchen, master bedroom with dressing room and private bathroom, 2 bedrooms with their own bathroom, multifunctional room, wardrobe, and terrace.

The luxury apartment is highlighted by the brightness of the spaces, both in the living room and in the 3 bedrooms, facing South and East.

This apartment is generously compartmentalized with a usable surface of 222.73sqm and a built surface of 275.41sqm. The apartment benefits of underground parking place.

The access is secured by a private system for the use of the entrances and the elevator, which realizes the direct connection between the underground garage, the entrance hall - reception and each apartment.



## Property details

<b>Rooms no.</b>	4
<b>Useable surface</b>	223m <sup>2</sup>
<b>Constructed surface</b>	276m <sup>2</sup>
<b>Apartment type</b>	Apartment
<b>Type of rooms</b>	Independent
<b>Type of comfort</b>	Deluxe
<b>Bedrooms no.</b>	3
<b>Kitchens no.</b>	1
<b>Bathrooms no.</b>	4
<b>Building type</b>	Block
<b>Year built</b>	2000
<b>Year renovated</b>	2016
<b>Config</b>	1S+P+7
<b>Floor</b>	1
<b>Balconies no.</b>	1
<b>State</b>	Finished
<b>Elevator</b>	Yes
<b>Parking inside</b>	1

## Amenities

 Equipped kitchen

 Dishwasher

 Not furnished

 Building heating

 Suitable for office

 Air conditioning



## Location

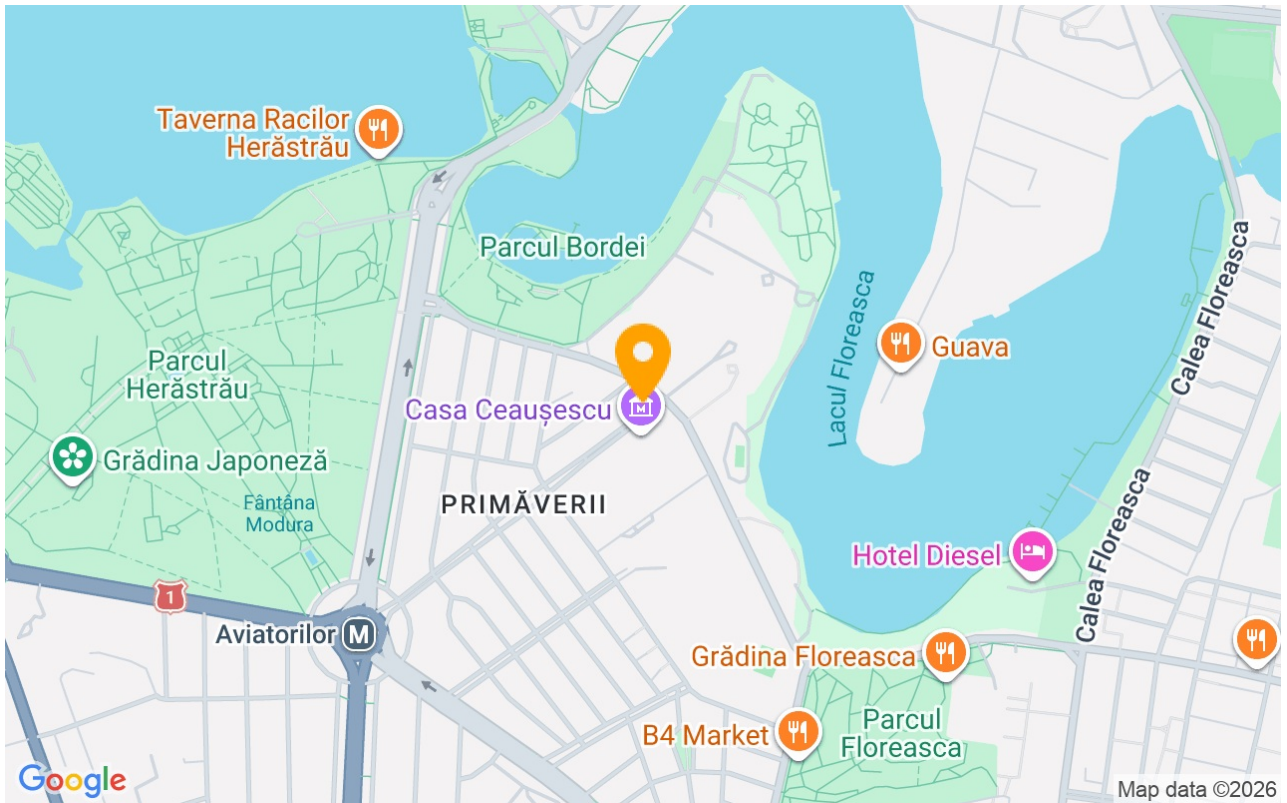

## Photos

