



**Violetta Tudorache**

+40 729 005 624

contact@blissimobiliare.ro  
(mailto:contact@blissimobiliare.ro)

Updated on 14 June 2026

## 4-Bedroom Villa with Pool and Generous Loft

**1,995,000 EUR** +VAT

Web Reference  
**#145351**

📍 Iancu Nicolae British School Bucharest,  
Bucharest / Ilfov

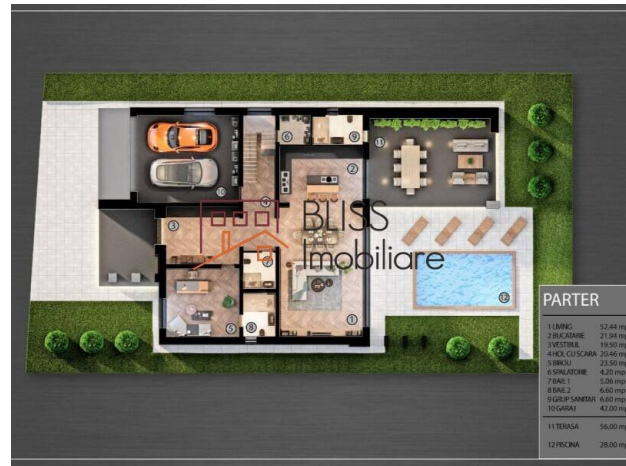

<https://www.blissimobiliare.ro/index.php/en/villa-4-bedrooms-for-sale-iancu-nicolae-pipera-bucharest-ilfov-145351> (<https://www.blissimobiliare.ro/index.php/en/villa-4-bedrooms-for-sale-iancu-nicolae-pipera-bucharest-ilfov-145351>)

### Description

This villa stands out through its generous scale, natural light and balanced layout, arranged over ground floor and first floor with 626 sqm of usable space on an 800 sqm plot. The day area includes a 52.44 sqm living room, a 21.94 sqm kitchen, vestibule, staircase hall, laundry room and a 23.50 sqm office that can also function as a guest or work-from-home space.

## Situated in one of Bucharest's the most sought after residential areas

Outdoors, the property is enhanced by a generous terrace, swimming pool, 640 sqm private garden and a 42 sqm garage, together with indoor parking for 2 cars. Upstairs, there are 3 spacious bedrooms, multiple dressing areas and an impressive 67.33 sqm loft that can easily become a lounge, hobby or family room.

Completed in 2026, unfurnished and equipped with its own central heating system, the house offers an excellent foundation for a tailored interior concept. Its setting in Iancu Nicolae | Pipera, close to British School Bucharest, adds practical value for a family seeking privacy, functionality and well-defined indoor-outdoor living.

For more details, contact BLISS Immobiliare.





## Property details

<b>Rooms no.</b>	5
<b>Useable surface</b>	626m <sup>2</sup>
<b>Constructed surface</b>	682m <sup>2</sup>
<b>Bedrooms no.</b>	4
<b>Kitchens no.</b>	1
<b>Bathrooms no.</b>	4
<b>Toilets no.</b>	1
<b>Building type</b>	Villa
<b>Year built</b>	2026
<b>Balconies no.</b>	1
<b>State</b>	Finished
<b>Total land</b>	800m <sup>2</sup>
<b>Print</b>	160m <sup>2</sup>
<b>Courtyard</b>	640m <sup>2</sup>
<b>Parking inside</b>	2
<b>From developer</b>	No

## Amenities

 Not furnished

 Private heating

 Swimming pool



## Location

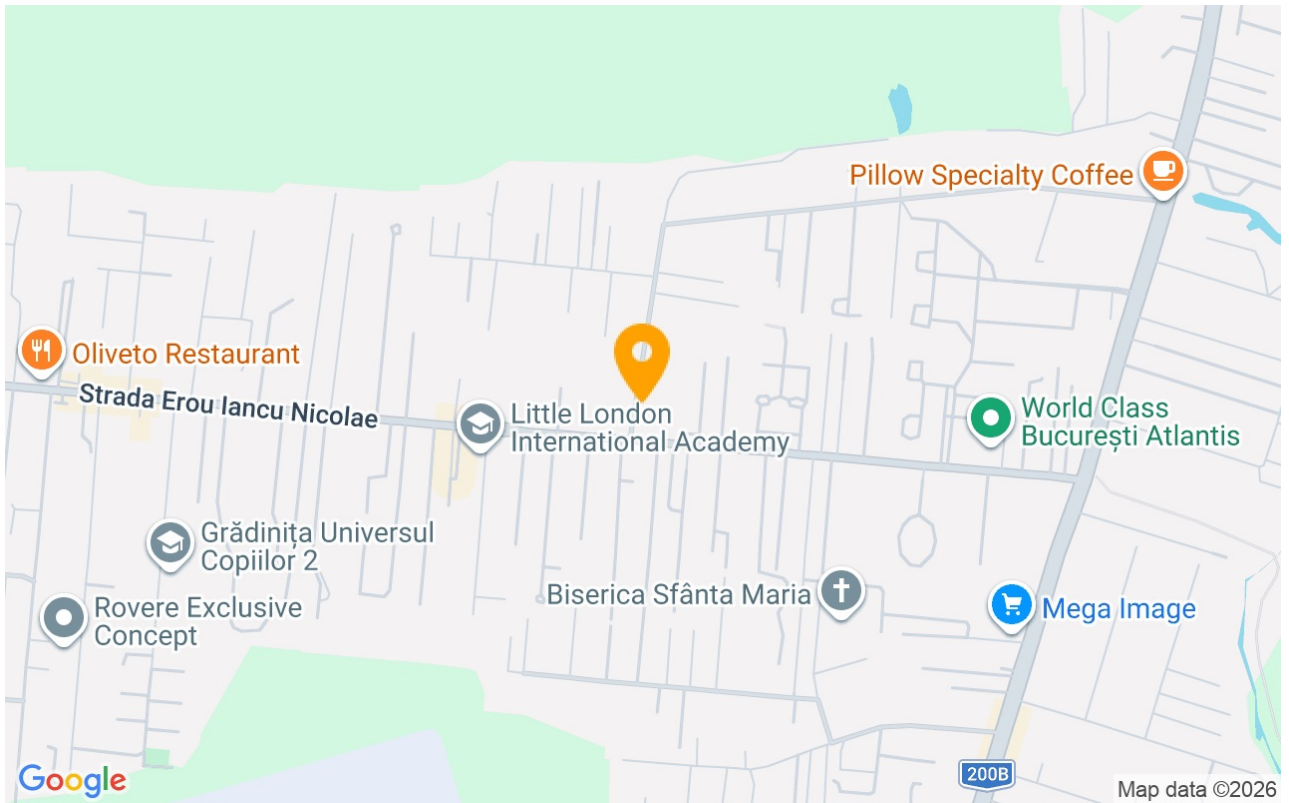

## Photos

